

Application Note

DAQ Configurations

VIC-3D

2026

DAQ Configuration

3D Low-Speed Hardware Triggering

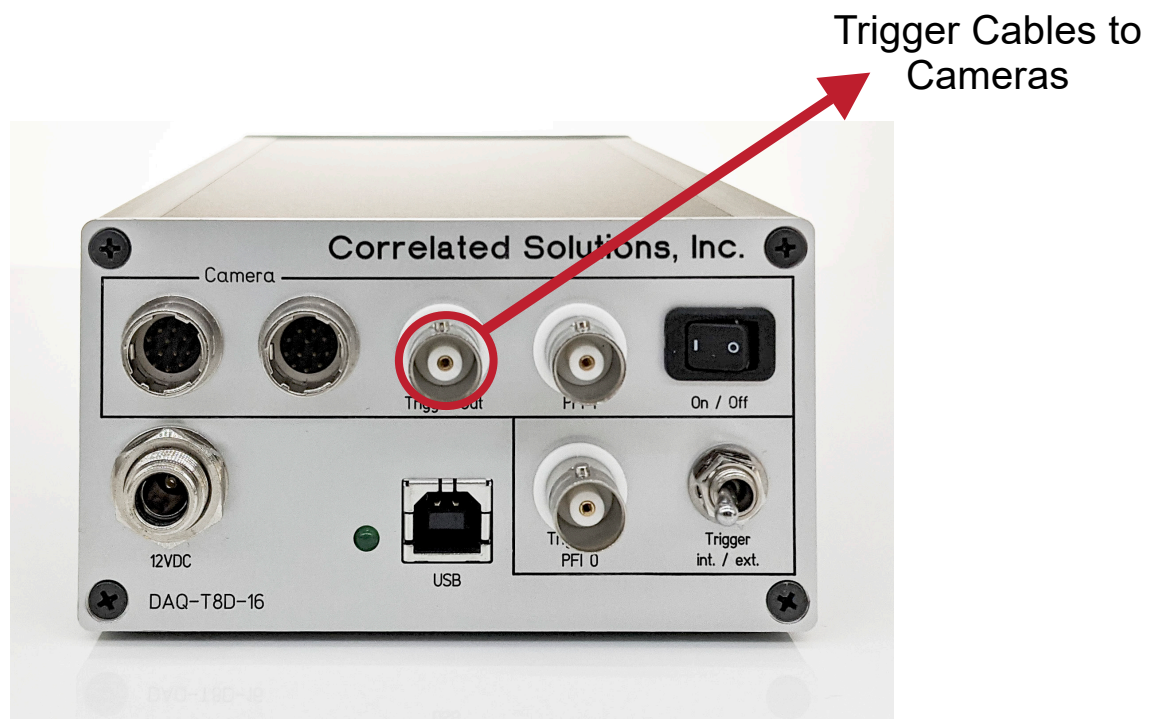

Analog Input
 $\pm 10\text{V}$

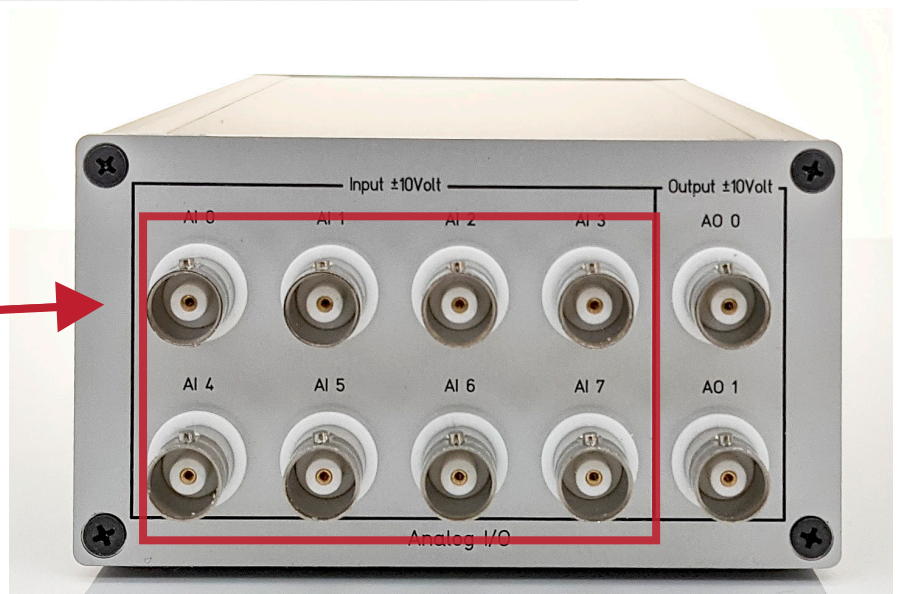



Trigger Cables to
Cameras

Analog Input
 $\pm 10\text{Volt}$



3D High-Speed Hardware Triggering

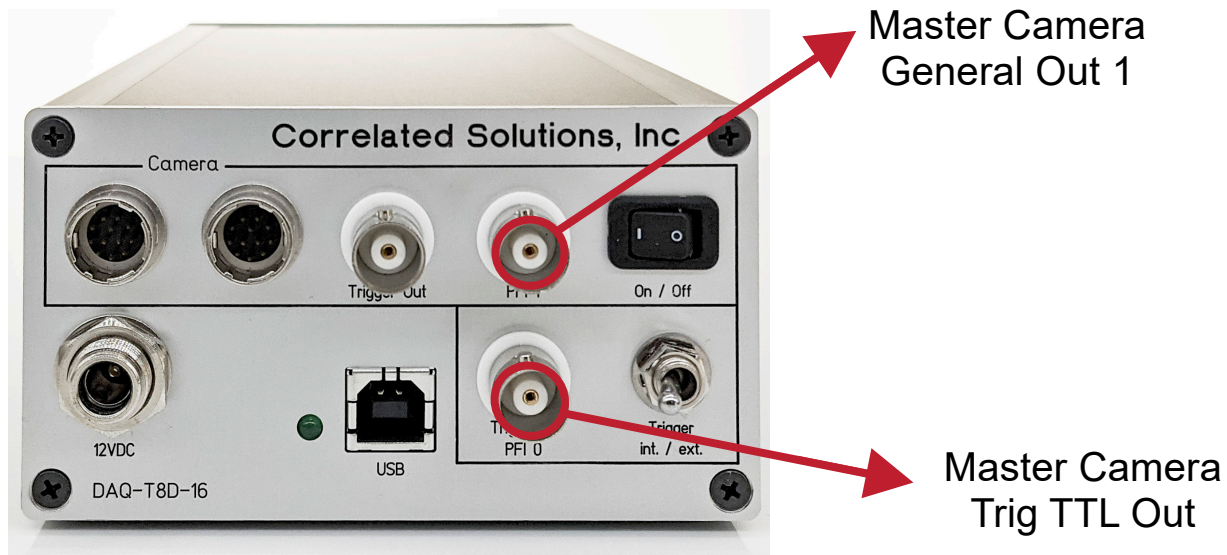

Analog Input
 $\pm 10\text{V}$





Analog Input
 $\pm 10\text{V}$



3D Fulcrum

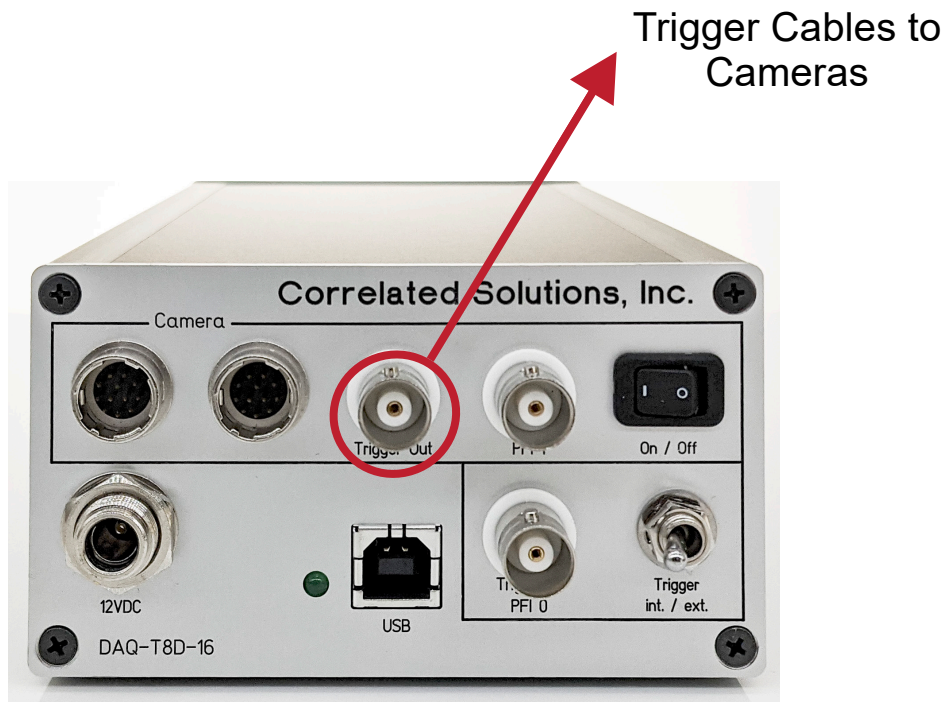

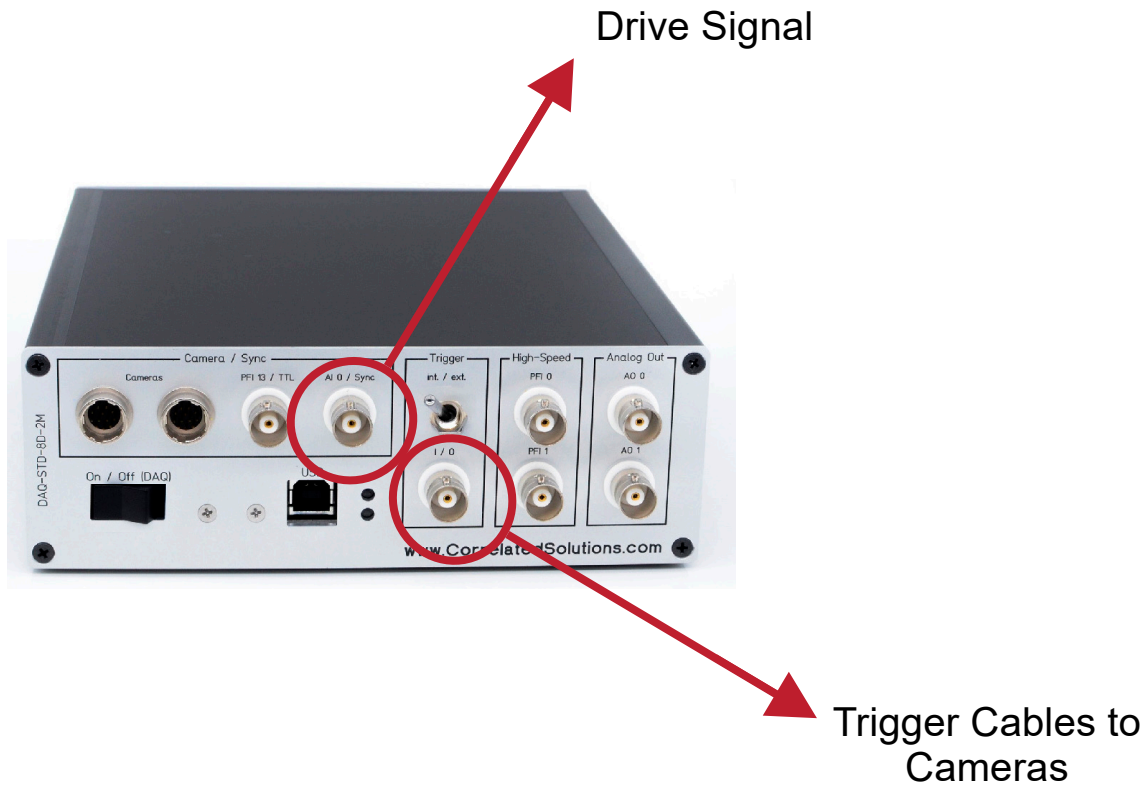

Analog Input
 $\pm 10\text{Volt}$



3D VIC-Gauge

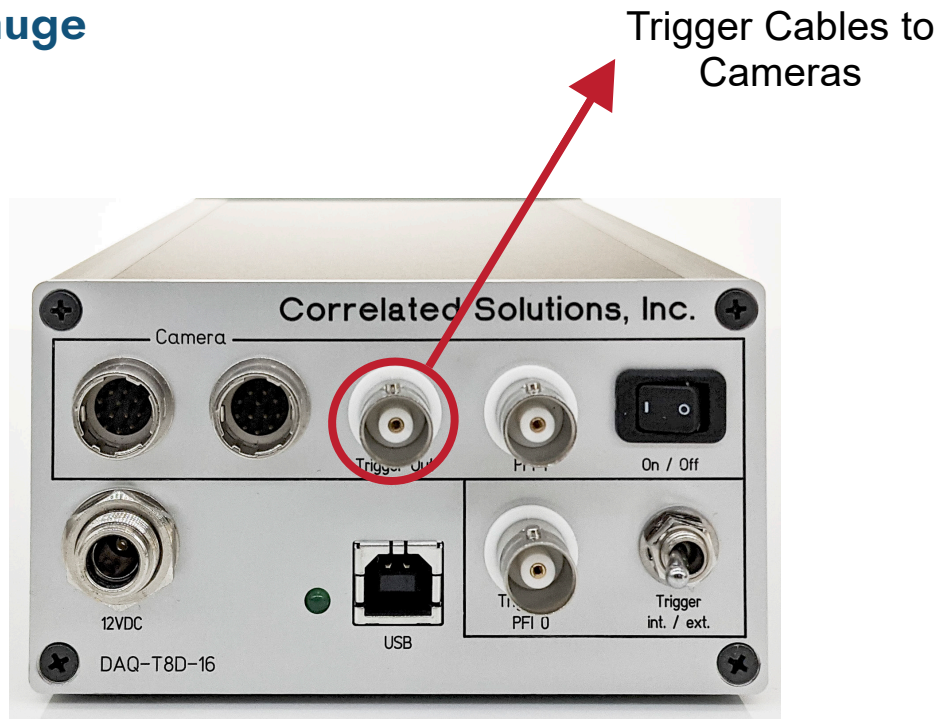

Analog Input
 $\pm 10\text{V}$

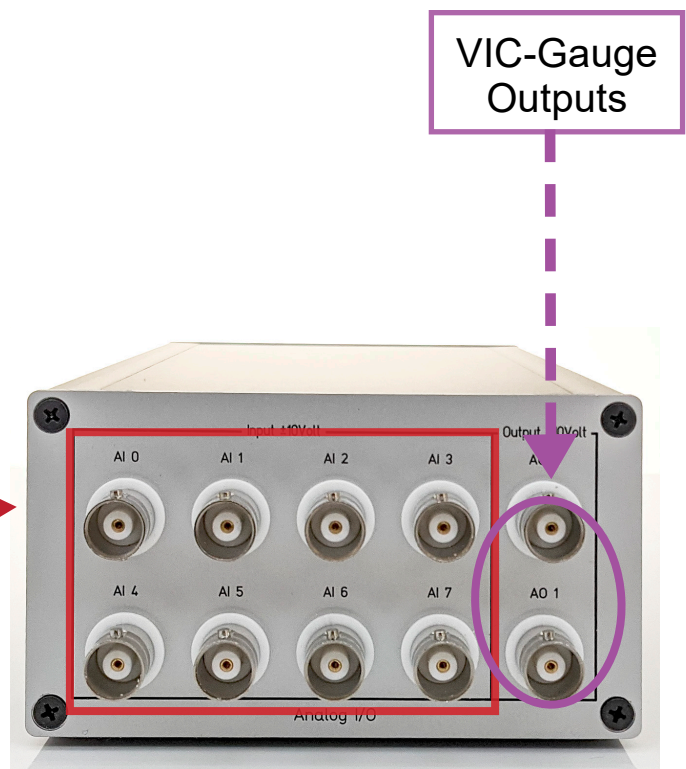

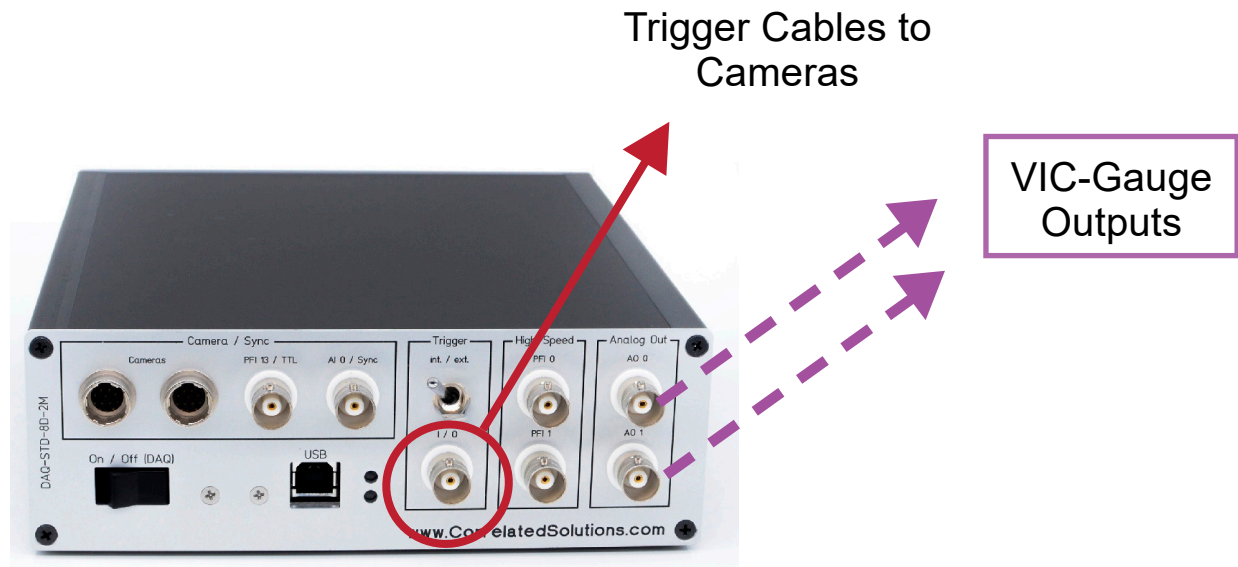

Analog Input
 $\pm 10\text{Volt}$



Other DAQ Information

VIC-Snap currently supports most NI analog data acquisition units that range from +/-10V. Within the advanced options menu, pictured below, settings for the DAQ device can be tailored to suit the user and analog data being captured. With the DAQ device plugged in, the device info for this device should be populated. If there is any issue with the DAQ device not populating the device info within the advanced options, or any other issues with the device and the Correlated Solutions, Inc. software, please contact our support engineers for assistance.

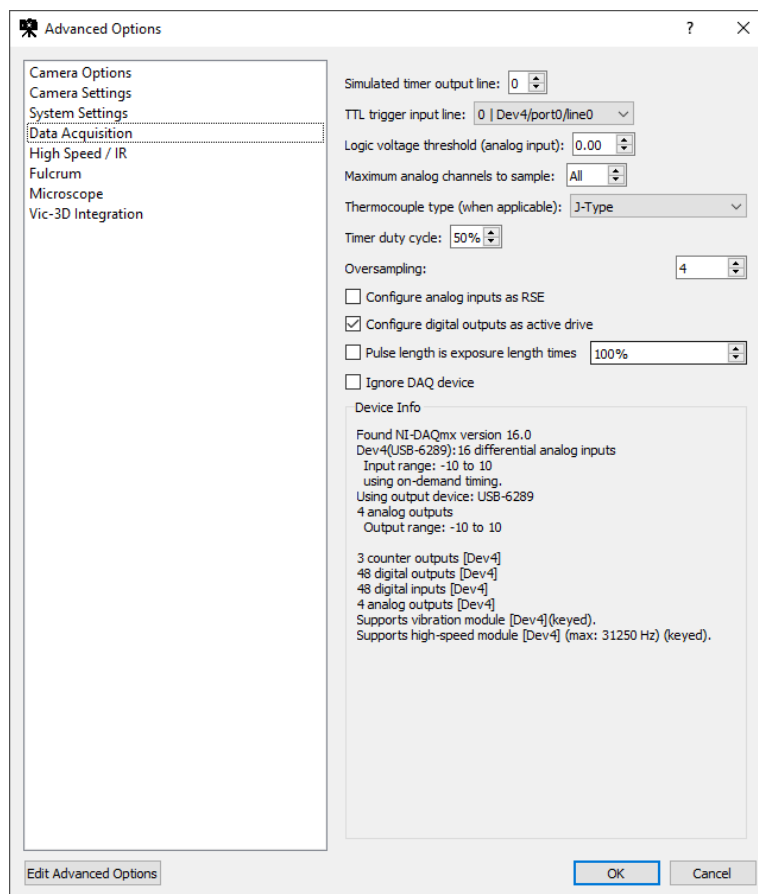

Support

If you have any questions about this document or any other questions, comments, or concerns about our software, please contact us at support@correlatedsolutions.com, or visit our website at correlatedsolutions.com/support.