

Application Note

DAQ Configurations

VIC-3D

2023

DAQ Configuration

3D Low-Speed Hardware Triggering

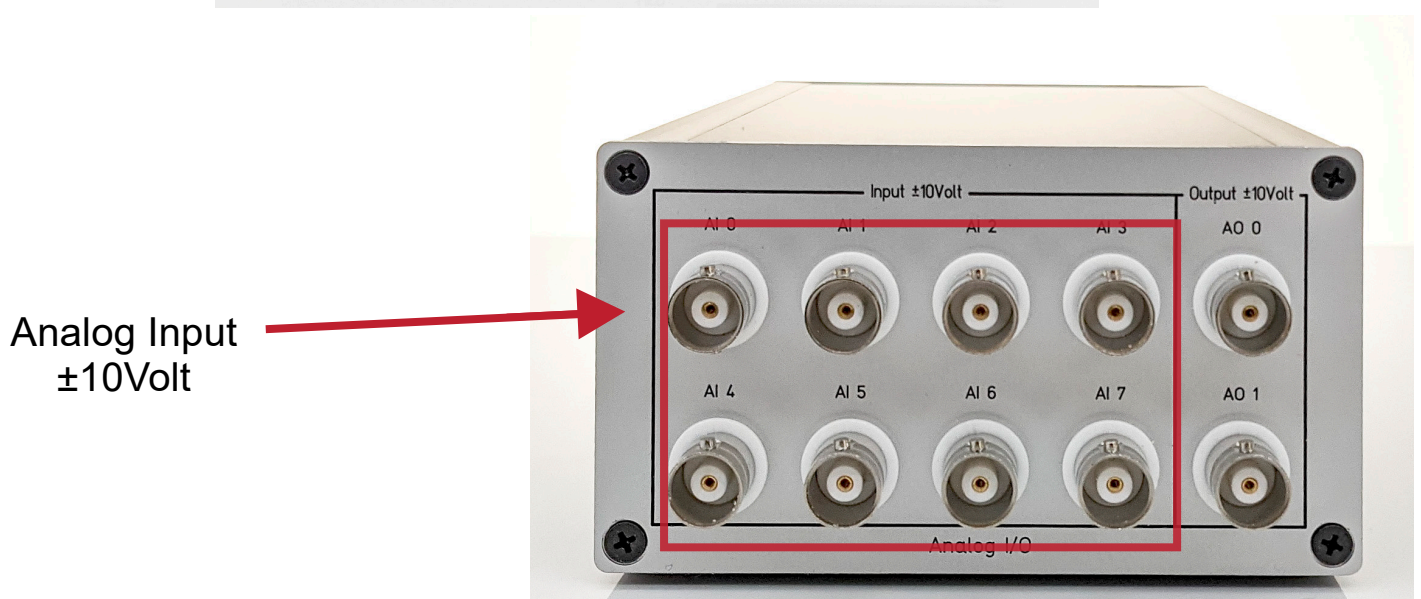
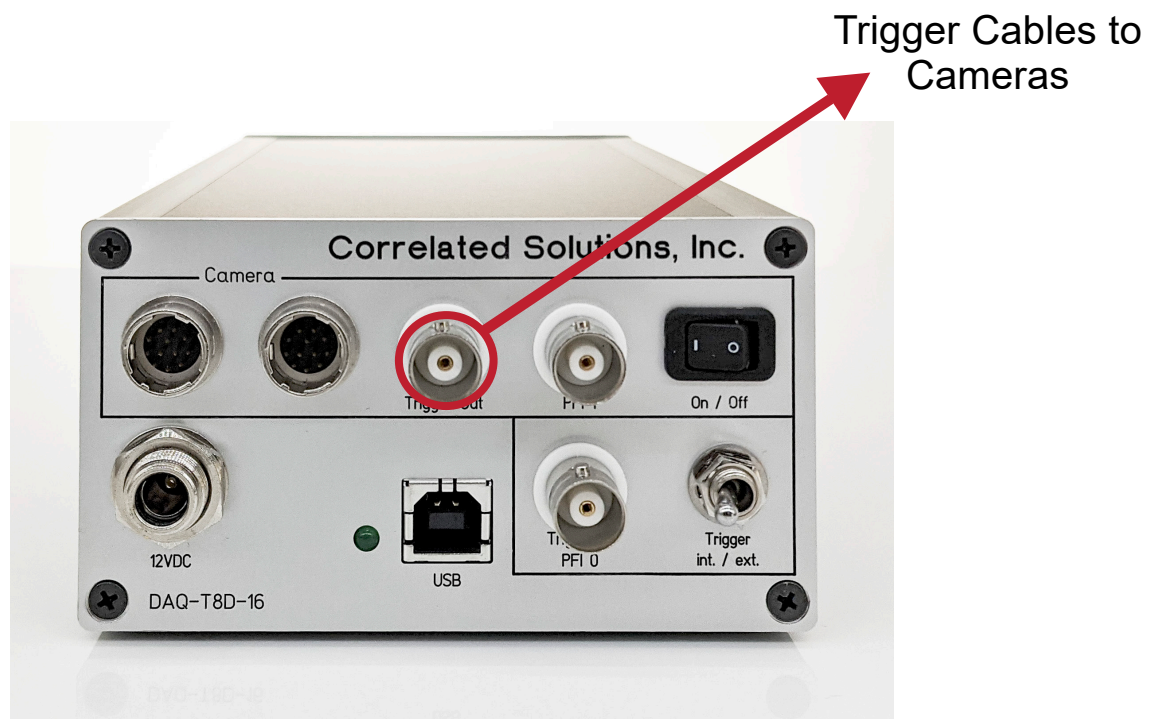

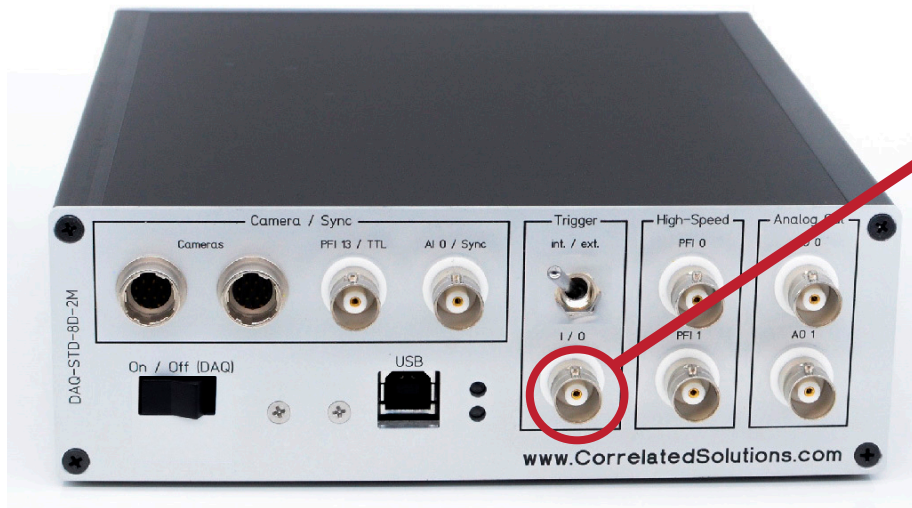

Trigger Cables to
Cameras

Analog Input
 ± 10 Volt



3D High-Speed Hardware Triggering

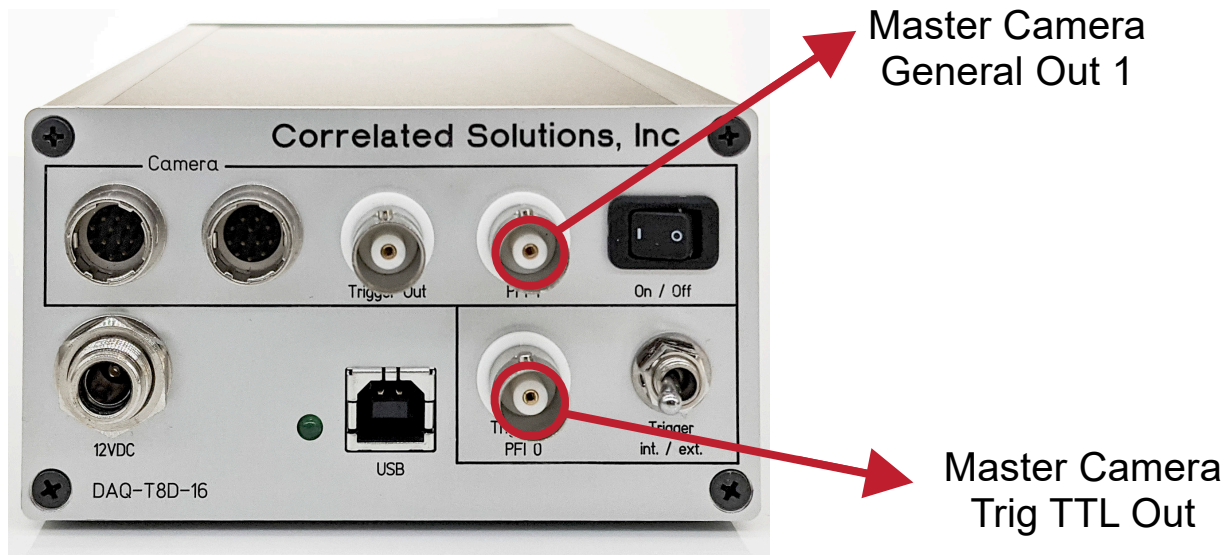

Analog Input
 $\pm 10\text{Volt}$





Master Camera
General Out 1

Master Camera
Trig TTL Out

Analog Input
 $\pm 10\text{Volt}$



3D Fulcrum

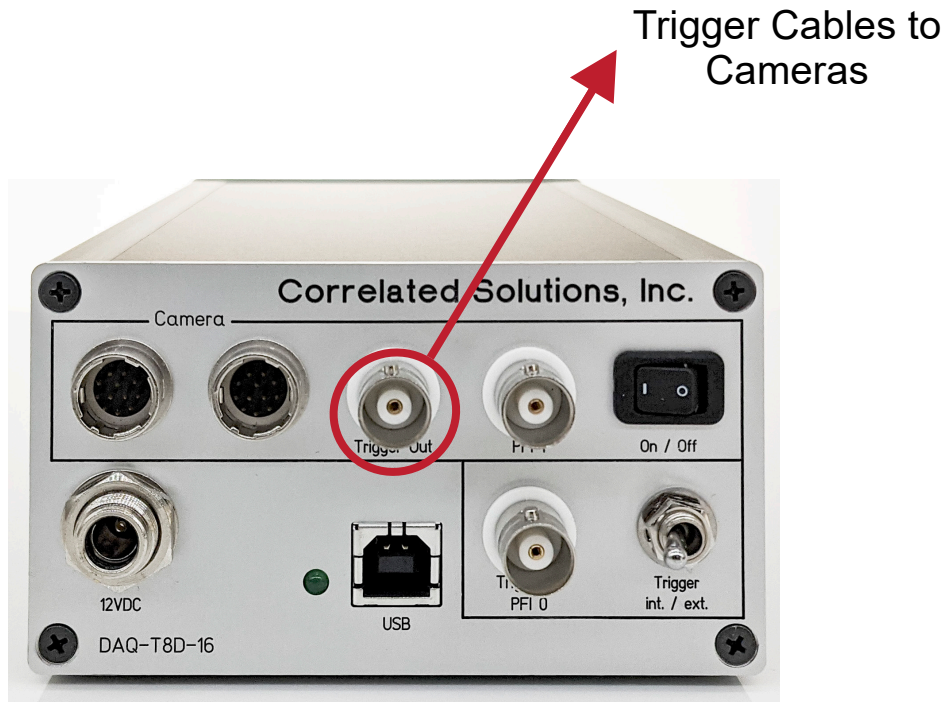

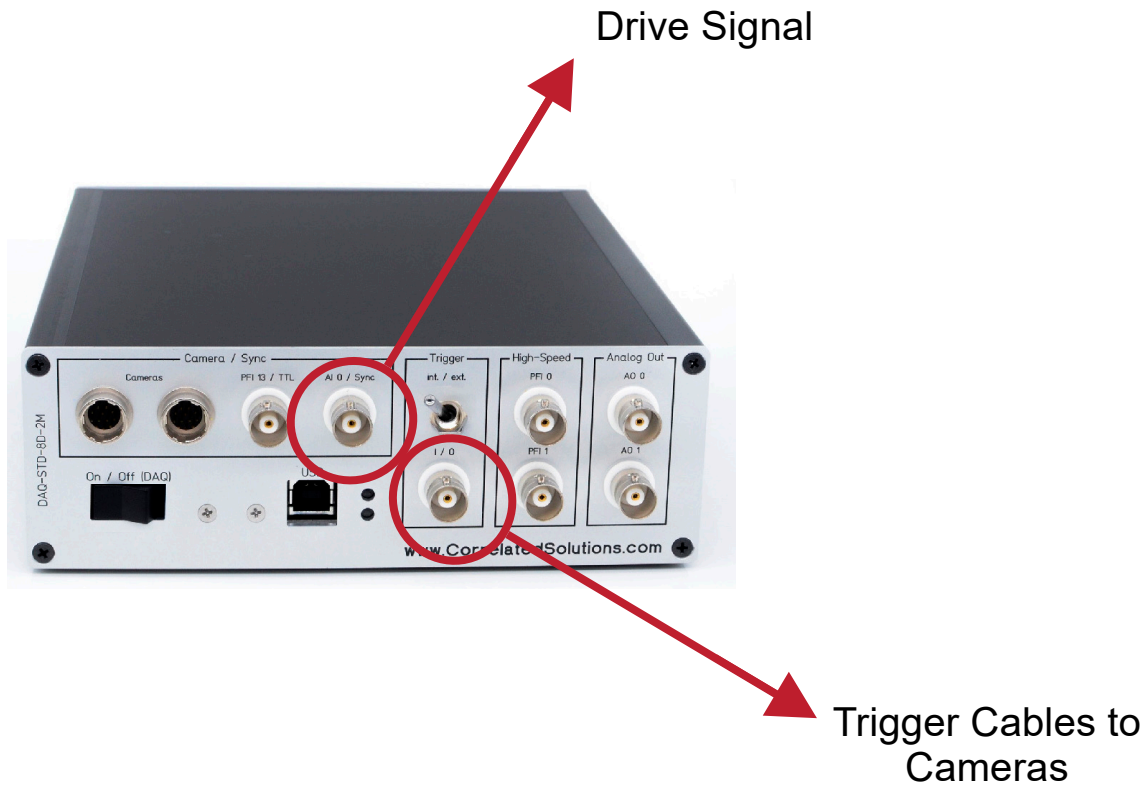

Analog Input
 ± 10 Volt



3D VIC-Gauge

Trigger Cables to
Cameras



VIC-Gauge
Outputs

Analog Input
 ± 10 Volt



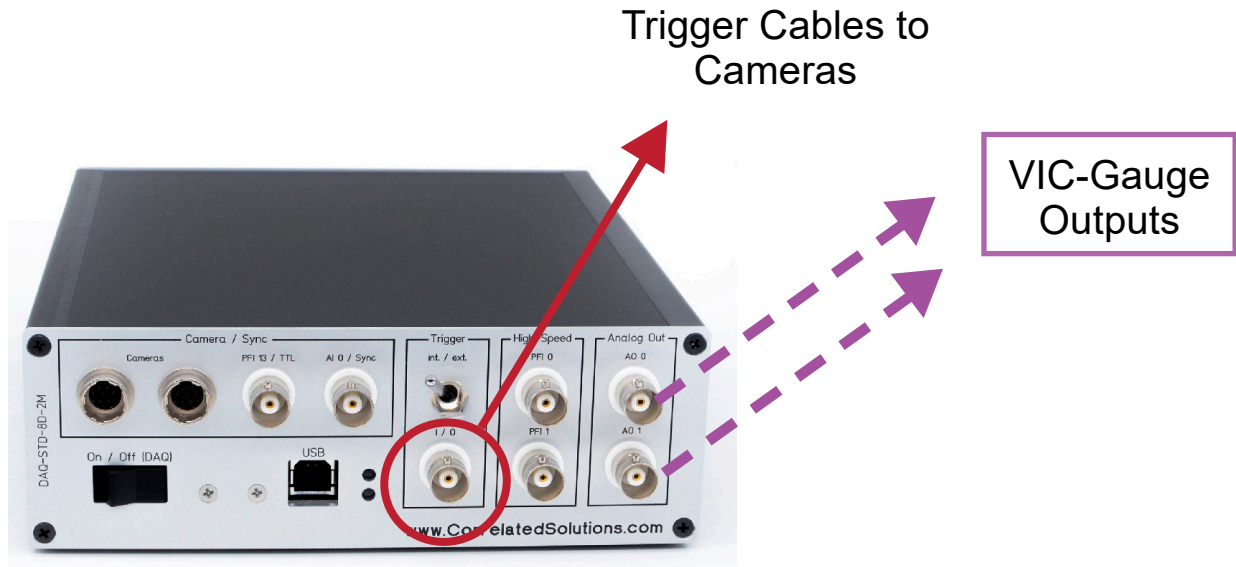

Analog Input
 ± 10 Volt



Other DAQ Information

VIC-Snap currently supports most NI analog data acquisition units that range from +/-10V. Within the advanced options menu, pictured below, settings for the DAQ device can be tailored to suit the user and analog data being captured. With the DAQ device plugged in, the device info for this device should be populated. If there is any issue with the DAQ device not populating the device info within the advanced options, or any other issues with the device and the Correlated Solutions, Inc. software, please contact our support engineers for assistance.

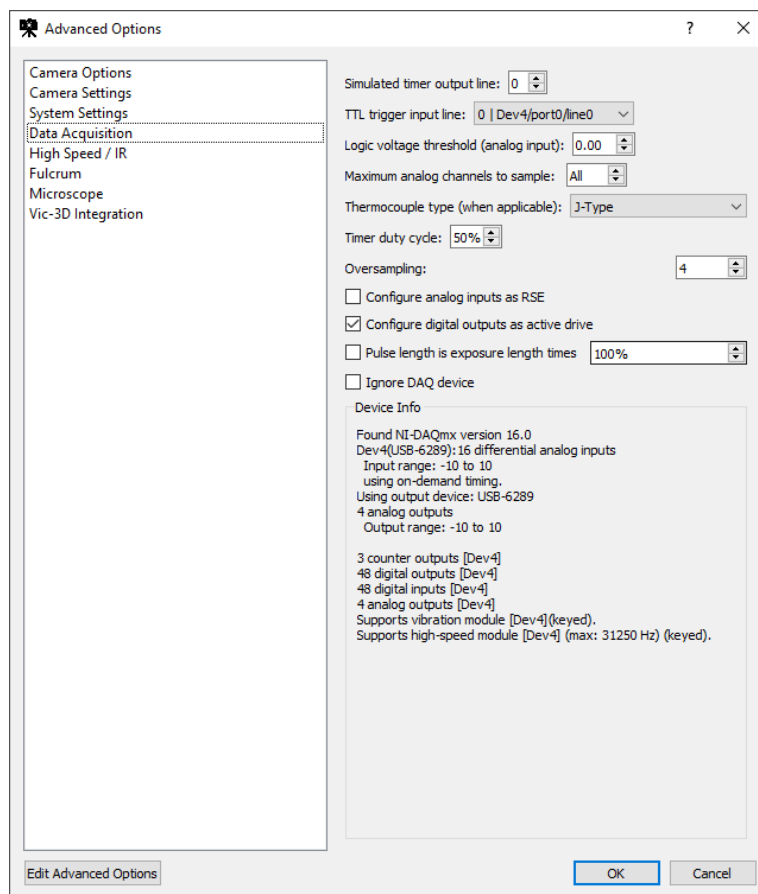

Support

If you have any questions about this document or any other questions, comments, or concerns about our software, please contact us at support@correlatedsolutions.com, or visit our website at correlatedsolutions.com/support.